

VERSA STEEL Approval Drawings

WATER RESERVOIR SECURITY HATCH, ST, NO SKIRT, SERIES 36 X 36

Assembly No.: VSH-200-A-36-36-STN-GS

ASSEMBLY NO./PART NUMBER KEY:

VSH= VERSA STEEL INC. HATCH
 200 = 200 P.S.F. RATED
 A= ALUMINUM CONSTRUCTION
 36-36= SIZE INTERIOR OPENING
 STN = SINGLE TEE FRAME SERIES, NO SKIRT
 GS= GAS SPRING

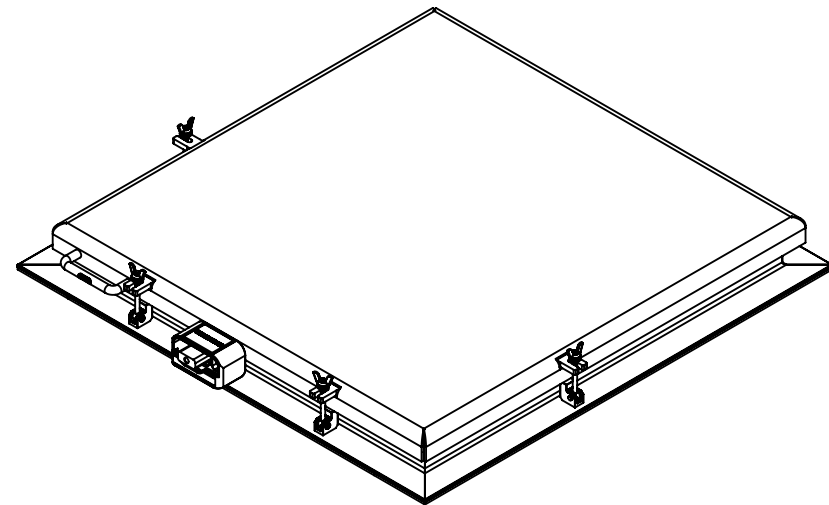

GENERAL SPECIFICATIONS:

1. UNIT IS WEATHER PROOF WITH CONTINOUS BULB SEAL ON LID TO FRAME AND 1/4" X 5-1/4" WIDE FRAME TO CURB SEALS.
2. LID OVER LAPS FRAME A MINIMUM OF 2 INCHES.
3. FRAME IS A MINIMUM OF 4" ABOVE THE CURB.
4. LID IS HINGED ON SIDE WITH TAMPER PROOF SCREWS AND PROVISION FOR A PADLOCK WITH TAMPER PROOF COVER. THERE ARE A MINIMUM OF FOUR SWING BOLT HOLD DOWNS TO SECURE THE HATCH FOR WEATHER PROOF SEAL.
5. HATCH IS DESIGNED FOR 200 P.S.F. LOAD.
6. THERE ARE 8 INTERIOR ATTACHMENT POINTS FOR SECURITY USING 1/2" FASTENER. THERE IS A FULL FACE GASKET OF 5-1/4" WIDE CLOSED CELL FOAM EPDM BETWEEN FRAME AND CURB.
7. LID IS A 1/4" 5086 ALUMINUM PLATE.
8. ALL FASTENERS AND HARDWARE ARE 316 STAINLESS STEEL.

THIS DOCUMENT CONTAINS PROPRIETARY, TRADE SECRET INFORMATION THAT IS THE PROPERTY OF VERSA STEEL, INC. THE INFORMATION CONTAINED IN THIS DOCUMENT, INCLUDING THE PRINCIPLE OF DESIGN, MAY NOT BE USED OR COPIED, IN WHOLE OR IN PART, WITHOUT THE EXPRESS PRIOR WRITTEN CONSENT OF VERSA STEEL, INC.

MATERIAL	6061-T6 ALUMINUM	DRAWN BY	E. BAILIFF	REV	A	DATE		BY	
FINISH	BARE	DATE	2009-08-13	REV	B	DATE		BY	
SHEET TITLE	PART NUMBER: VSH-200-A-36-36-STN-GS	CHECKED BY		REV	C	DATE		BY	
PART NUMBER	VSH-200-A-36-36-STN-GS	APPROVED BY		REV	D	DATE		BY	
SUPPLIER	FABRICATED PART	PART NUMBER	VSH-200-A-36-36-STN-GS	REV	E	DATE		BY	
SCALE	1:16	WATER RESERVOIR SECURITY HATCH, ST, NO SKIRT, SERIES 36 X 36		REV	F	DATE		BY	
DRAWING NO.	VSH-200-A-36-36-STN-GS-AF	MATERIAL	6061-T6 ALUMINUM	REV	G	DATE		BY	
REVISION NO.	A	FINISH	BARE	VERSA STEEL, INC. 1618 NE FIRST AVENUE PORTLAND, OREGON 97232 (503)287-9822 FAX (503)-287-7483					
SHEET NO.	1	SHEET TITLE	PART NUMBER: VSH-200-A-36-36-STN-GS						
				WATER RESERVOIR SECURITY HATCH, ST, NO SKIRT, SERIES 36 X 36					
				1 OF 4					

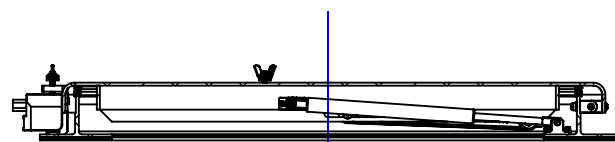
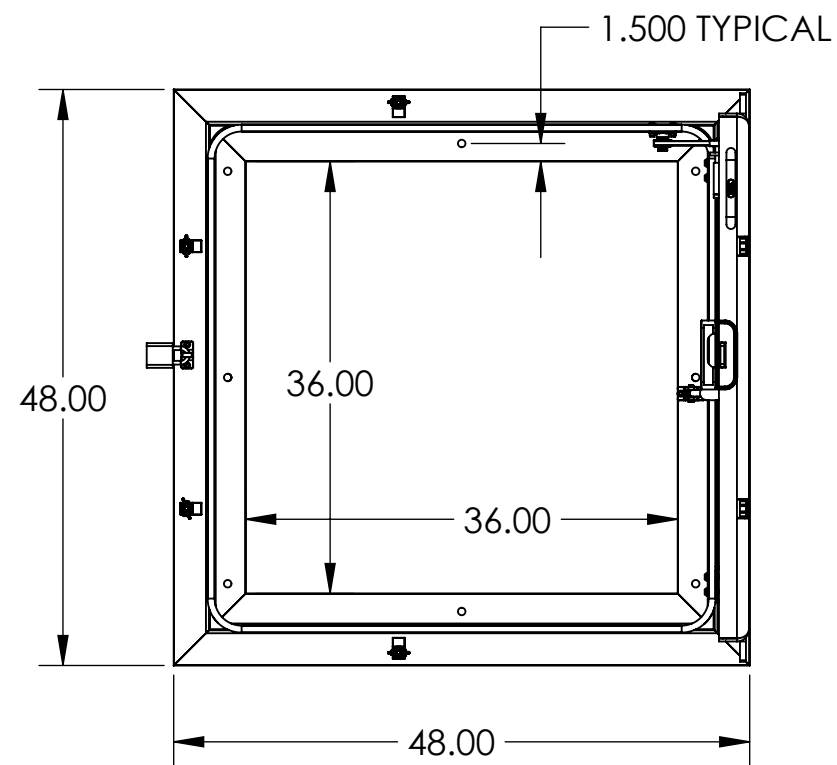
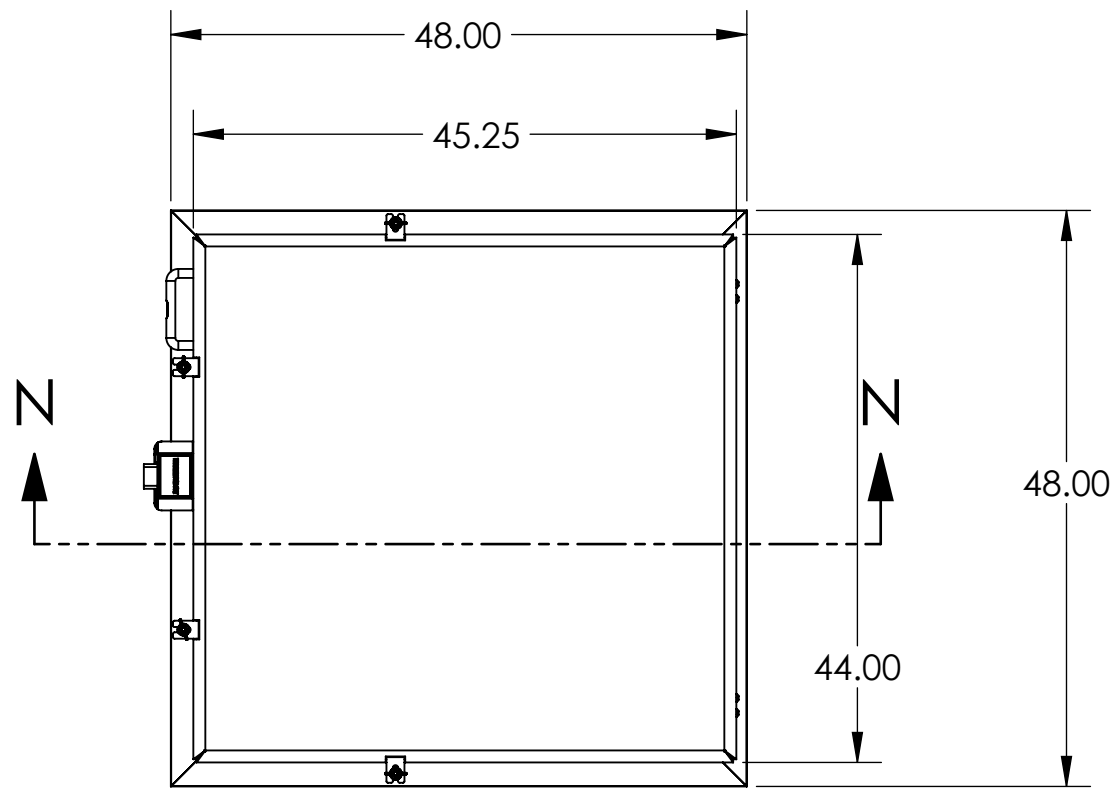

SECTION N-N

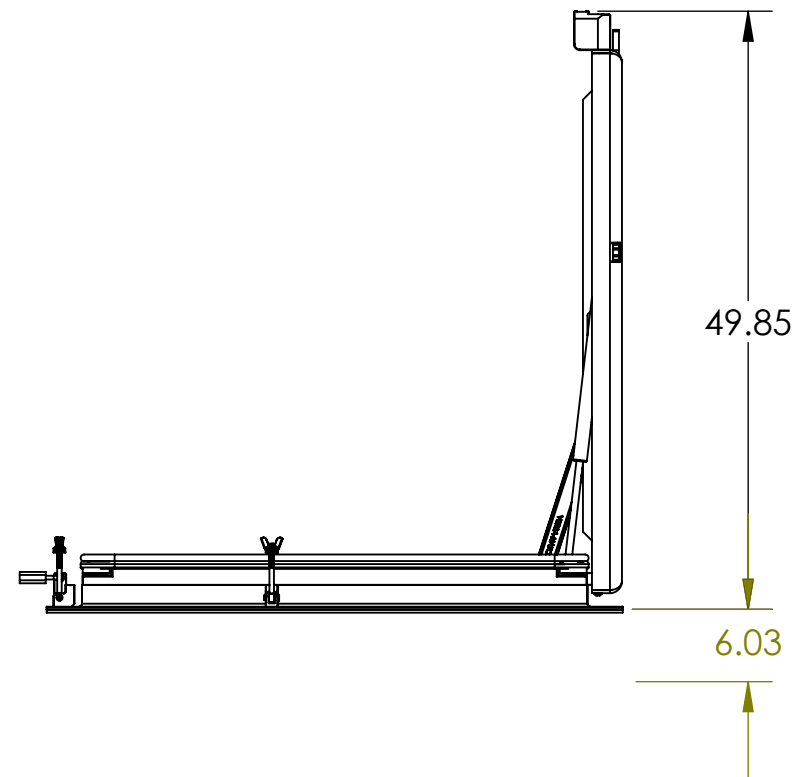
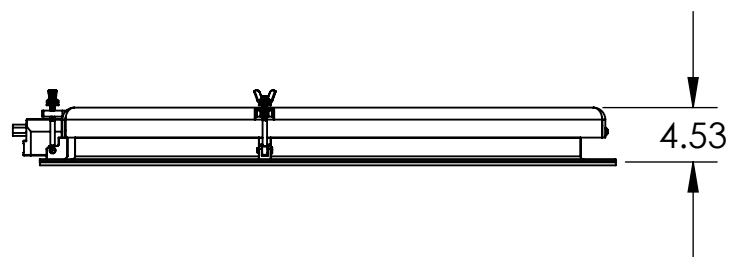

NOTES:
 PN: VSH-200-A-36-36-STN-GS
 DESC: WATER RESERVOIR SECURITY HATCH, ST, NNO SKIRT, SERIES 36 X 36
 MATRL: 6061-T6 ALUMINUM
 EST. WT: 129.3
 FINISH: BARE
 NOTE: -
 CAD FILE: VSH-200-A-36-36-STN-GS-APPROVAL

THIS DOCUMENT CONTAINS PROPRIETARY, TRADE SECRET, INFORMATION THAT IS THE PROPERTY OF VERSA STEEL, INC. THE INFORMATION CONTAINED IN THIS DOCUMENT, INCLUDING THE PRINCIPLE OF DESIGN, MAY NOT BE USED OR COPIED, IN WHOLE OR IN PART, WITHOUT THE EXPRESS PRIOR WRITTEN CONSENT OF VERSA STEEL, INC.

MATERIAL	6061-T6 ALUMINUM	DRAWN BY	E. BAILIFF
FINISH	BARE	DATE	2009-08-13
SHEET TITLE	WATER RESERVOIR SECURITY HATCH, ST, NNO SKIRT, SERIES 36 X 36	CHECKED BY	
PART NUMBER	VSH-200-A-36-36-STN-GS	APPROVED BY	
SUPPLIER	FABRICATED PART		
SCALE	1:16		
DRAWING NO.	VSH-200-A-36-36-STN-GS-AP		
REVISION NO.	A		
SHEET NO.	2		
	OF 4		
		REV	ISSUED FOR
		A	
		B	
		C	
		D	
		E	
		F	
		G	
			DATE
			BY

VERSA STEEL, INC.
 1618 NE FIRST AVENUE
 PORTLAND, OREGON 97232
 (503)287-9822
 FAX (503)-287-7483

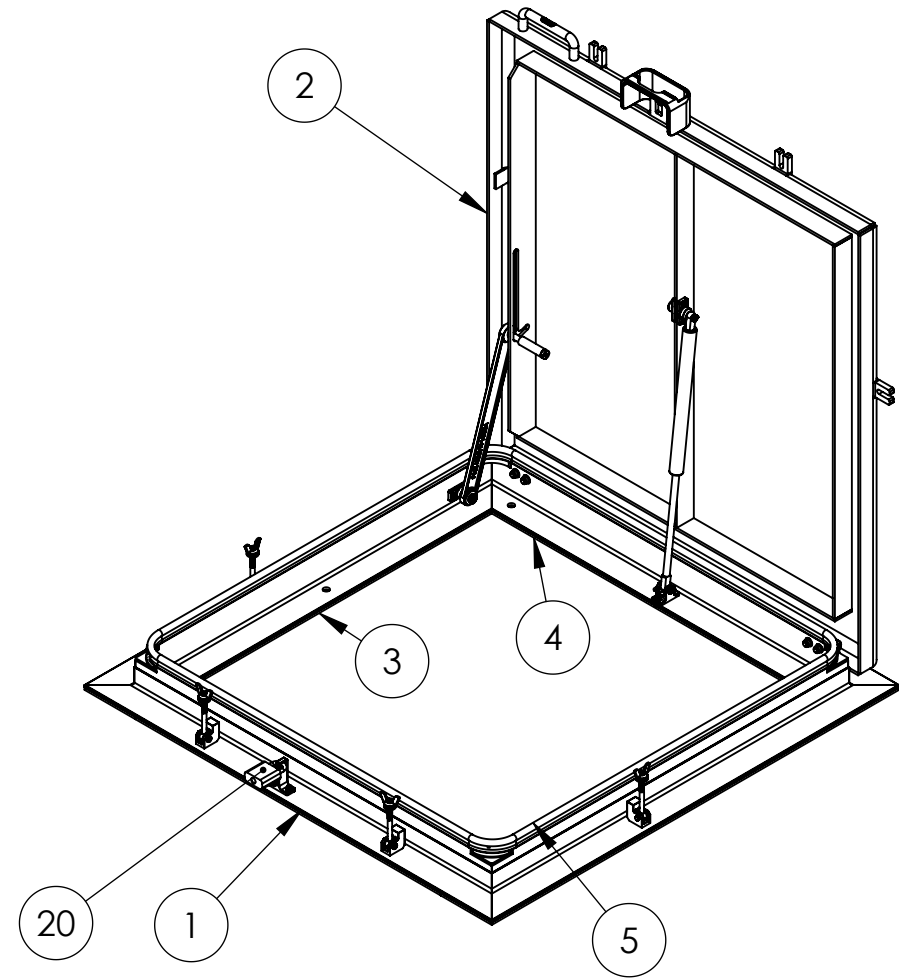

SEE SHEET 4 FOR DETAIL CALLOUTS

NOTES:
 PN: VSH-200-A-36-36-STN-GS
 DESC: WATER RESERVOIR SECURITY HATCH, ST, NNO SKIRT, SERIES 36 X 36
 MATRL: 6061-T6 ALUMINUM
 EST. WT: 129.3
 FINISH: BARE
 NOTE: -
 CAD FILE: VSH-200-A-36-36-STN-GS-APPROVAL

ITEM NO.	PART NUMBER	DESCRIPTION	QTY
1	7000660-36X36-STN	T-FRAME, NO SKIRT 36 X 36	1
2	7000649-36X36	LID WELDMENT, T-FRAME 36 X 36	1
3	1001726-36	SEAL, BASE SIDE 36	2
4	1001725-36	SEAL, BASE WIDTH 48	2
5	1000559-36X36	HATCH SEAL, 36 X 36	1
6	1000740	DATA PLATE	1
7	C6LB-U12-6	LOCK BOLT STAINLESS 3/8" DIA (1/4" TO 1/2" GRIP RANGE)	4
8	3LC-2CU-12	HUCK LOCKING COLLAR, 3LC, 3/8", STAINLESS	4
9	1000793-06	SRING LOCK WASHER, 3/8", 316	4
10	1000792-06	WASHER, 3/8" 316, WIDE	4
11	VS-37	.375 Dia External, single turn, retaining ring-T316	5
12	1000059	ROD END 3/8" ID X 3/4" OD X 4 1/2" LG W/ 3/8-16 THRD X 2" LG	4
13	1000061	WING NUT, 3/8-16 UNC	4
14	1000664	Clevis Pin 3/8x1	4
15	GFI-0809-08	FLANGED BEARING	1
17	9446K71	LOCK BAR COVERING, GP PVC TUBING, RED	1
17	1000656	Shoulder Bolt 1/2x5/8	1
18	1000524-24	3/4" HOLD OPEN ARM, 24, 316 SST	1
19	1000844-08	WASHER, 1/2" ID X .06", NYLON	1
20	PADLOCK	PADLOCK, BY OTHERS, REFERENCE	1
21	1000657	Shoulder Bolt 3/8x 1/2	1
22	1000756	Clevis Pin 3/8x1-1/4	1
23	1165-10-350-C2C2	STAINLESS STEEL GAS SPRINGS, 10" STROKE, 350 LBS	1
24	1000060	SH SHOULDER SCREW, 3/8"-16 X 1/2" X 4.0 LG 316	1

TOLERANCES:

DIMENSIONS ARE IN INCHES
 TOLERANCES:
 X.XX ± 0.020"
 X.XXX ± 0.005"
 UNLESS NOTED

THIS DOCUMENT CONTAINS PROPRIETARY, TRADE SECRET, INFORMATION THAT IS THE PROPERTY OF VERSA STEEL, INC. THE INFORMATION CONTAINED IN THIS DOCUMENT, INCLUDING THE PRINCIPLE OF DESIGN, MAY NOT BE USED OR COPIED, IN WHOLE OR IN PART, WITHOUT THE EXPRESS PRIOR WRITTEN CONSENT OF VERSA STEEL, INC.

VERSA STEEL, INC. 1618 NE FIRST AVENUE PORTLAND, OREGON 97232 (503)287-9822 FAX (503)-287-7483	
DRAWN BY	E. BAILIFF
DATE	2009-08-13
CHECKED BY	
APPROVED BY	
MATERIAL	6061-T6 ALUMINUM
FINISH	BARE
SHEET TITLE	WATER RESERVOIR SECURITY HATCH, ST, NNO SKIRT, SERIES 36 X 36
PART NUMBER	VSH-200-A-36-36-STN-GS
SUPPLIER	
FABRICATED PART	
SCALE	1:16
DRAWING NO.	VSH-200-A-36-36-STN-GS-AP
REVISION NO.	A
SHEET NO.	3 OF 4

REV	ISSUED FOR	DATE	BY
G			
F			
E			
D			
C			
B			
A			

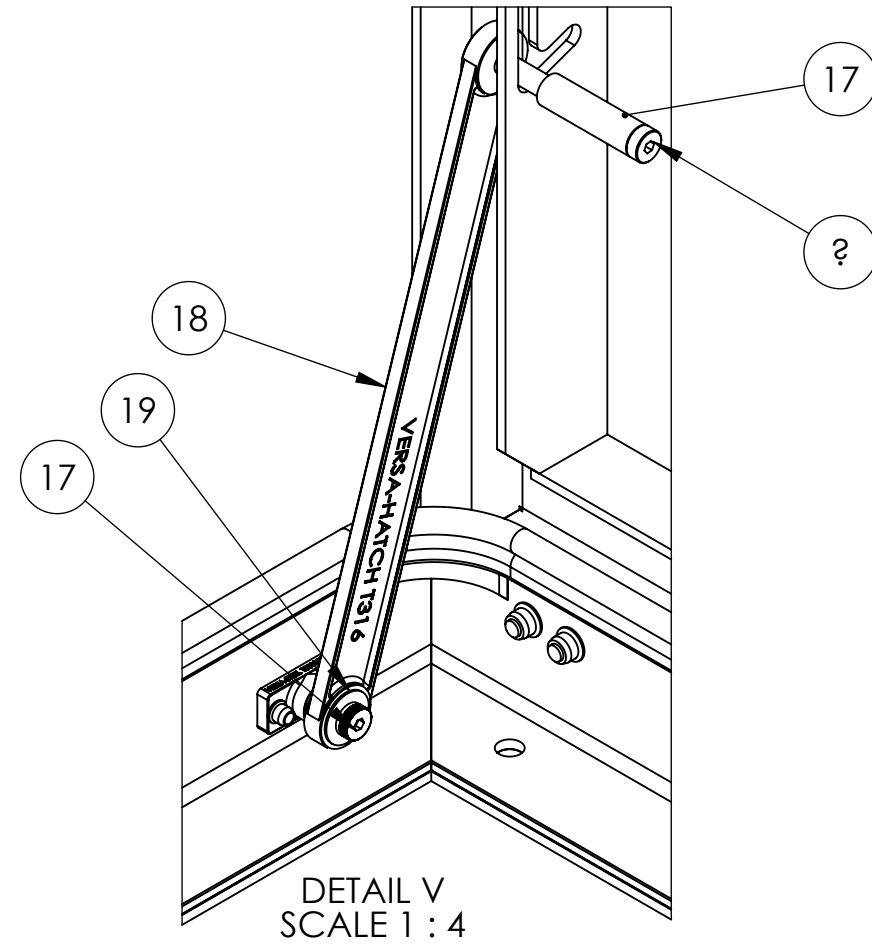
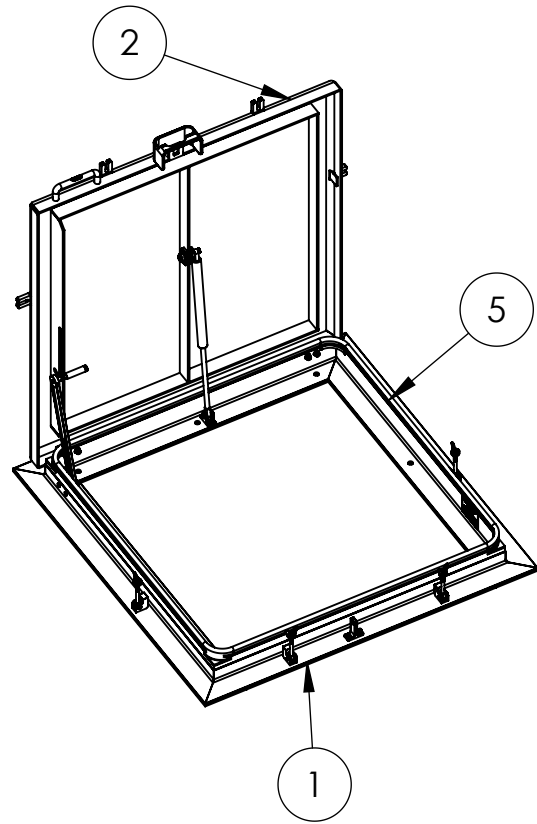
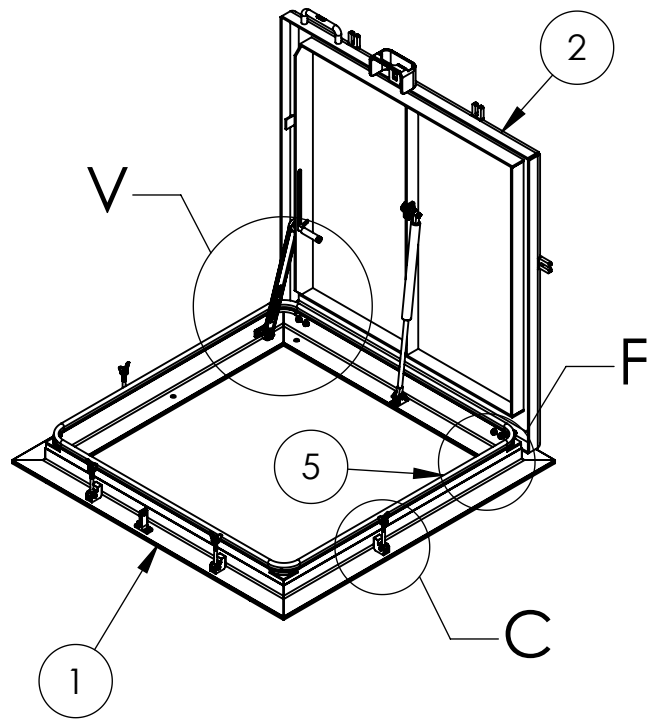

DETAIL V
SCALE 1 : 4

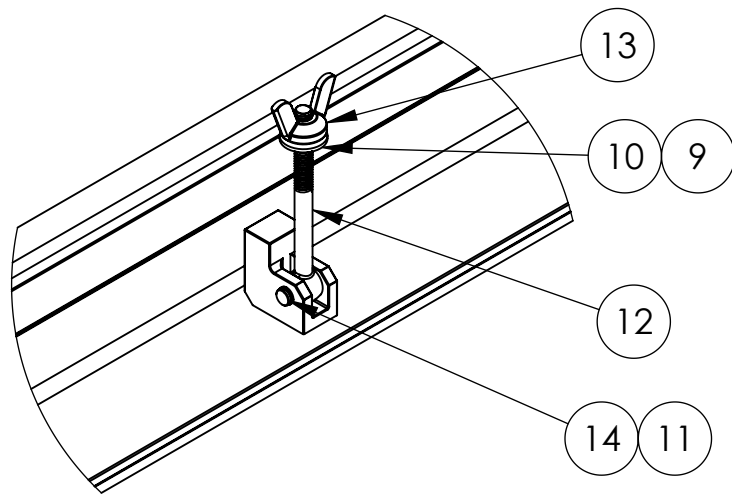

DETAIL C
SCALE 1 : 4

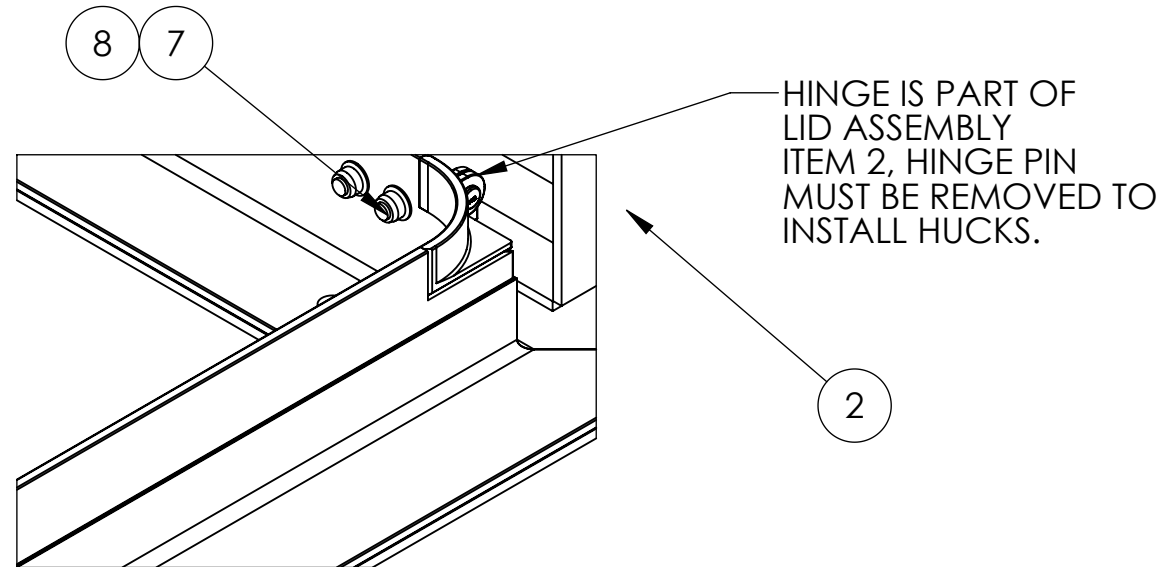

DETAIL F
SCALE 1 : 4

TOLERANCES:

DIMENSIONS ARE IN INCHES
TOLERANCES:

X.XX ± 0.020"
X.XXX ± 0.005"
UNLESS NOTED

THIS DOCUMENT CONTAINS PROPRIETARY, TRADE SECRET INFORMATION THAT IS THE PROPERTY OF VERSA STEEL, INC. THE INFORMATION CONTAINED IN THIS DOCUMENT, INCLUDING THE PRINCIPLE OF DESIGN, MAY NOT BE USED OR COPIED, IN WHOLE OR IN PART, WITHOUT THE EXPRESS PRIOR WRITTEN CONSENT OF VERSA STEEL, INC.

VERS STEEL, INC.
1618 NE FIRST AVENUE
PORTLAND, OREGON 97232
(503)287-9822
FAX (503)-287-7483

DRAWN BY
E. BAILIFF
DATE
2009-08-13
CHECKED BY

APPROVED BY

MATERIAL
6061-T6 ALUMINUM
FINISH
BARE
SHEET TITLE
WATER RESERVOIR SECURITY HATCH, ST, NNO SKIRT, SERIES 200
PART NUMBER: VSH-200-A-36-36-STN-GS

PART NUMBER
VSH-200-A-36-36-STN-GS
SUPPLIER
FABRICATED PART
SCALE
1:24
DRAWING NO.
VSH-200-A-36-36-STN-GS-AP
REVISION NO.
A
SHEET NO.
4 OF 4

G	ISSUED FOR	BY
F	DATE	
E		
D		
C		
B		
A		
REV		