

LID SEAL, COMPLETE PERIMETER OF LID & FRAME

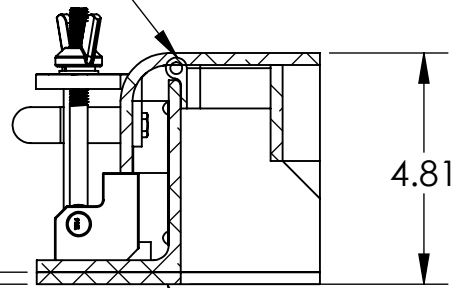

.25 GASKET

FRAME TO CURB SEAL COMPLETE PERIMETER OF FRAME

SECTION C-C
SCALE 1 : 4

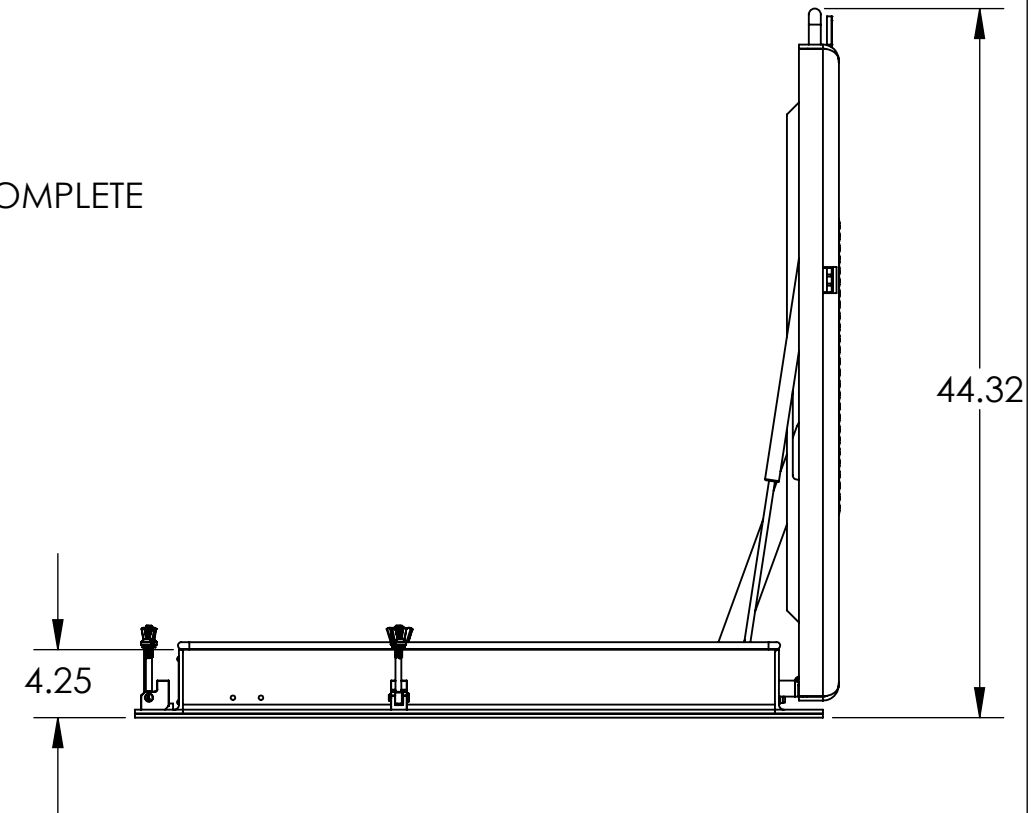
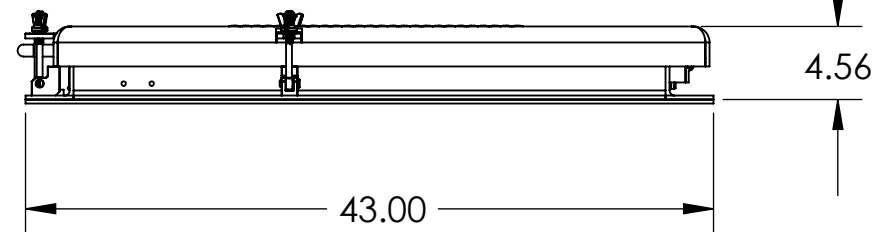

NOTES:
 PN: VSH-150-A-37-30-S-GS
 DESC: HATCH ASSEMBLY-GAS SPRING, 37 X 30
 MATRL: 6061-T6 ALUMINUM
 EST. WT: 86.3
 FINISH: BARE
 NOTE: -
 CAD FILE: VSH-150-A-37-30-S-GS-SPEC

THIS DOCUMENT CONTAINS PROPRIETARY, TRADE SECRET INFORMATION THAT IS THE PROPERTY OF VERSA STEEL, INC. THE INFORMATION CONTAINED IN THIS DOCUMENT, INCLUDING THE PRINCIPLE OF DESIGN, MAY NOT BE USED OR COPIED, IN WHOLE OR IN PART, WITHOUT THE EXPRESS PRIOR WRITTEN CONSENT OF VERSA STEEL, INC.

VERSA STEEL, INC.
 1618 NE FIRST AVENUE
 PORTLAND, OREGON 97232
 (503)287-9822
 FAX (503)-287-7483

DRAWN BY
 E. BAILIFF
 DATE
 2009-08-05
 CHECKED BY

APPROVED BY

MATERIAL
 6061-T6 ALUMINUM
 FINISH
 BARE
 SHEET TITLE
 HATCH ASSEMBLY-GAS SPRING, 37 X 30
 PART NUMBER: VSH-150-A-37-30-S-GS

PART NUMBER
 VSH-150-A-37-30-S-GS
 SUPPLIER
 FABRICATED PART
 SCALE
 1:12
 DRAWING NO.
 VSH-150-A-37-30-S-GS-SPEC
 REVISION NO.
 A

SHEET NO.
 2 OF 2

REV	ISSUED FOR	DATE	BY
G			
F			
E			
D			
C			
B			
A			